

vSolution Cynap™ Core: Collaboration & wireless presentation.



Cynap Core: Core essentials for collaboration & presentation!

Cynap Core provides the core essential features you need for effective collaboration, and wireless presentation. This powerful, secure, and easy-to-use collaboration system provides a complete all-in-one meeting room solution. It is also a key component of our vSolution MATRIX active learning classroom collaboration solution.

Implementation advantages

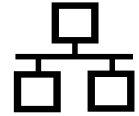

The ability to configure three separate networks (ie. BYOD WiFi, control and admin, and internet service, offers significant advantages when planning your working and learning environments.

App-free, dongle-free screen sharing!



Connect and share your screen using the wireless technology that's built into your own mobile device. Our wireless BYOD solution suits all iOS, iPadOS, Android, Chrome OS, Windows and Mac devices - with full support for AirPlay, Chromecast, and Miracast screen mirroring.

Instant access to Zoom meetings!



Cynap Core provides support for Zoom video meetings. It's possible to start an instant meeting or join a scheduled Zoom meeting directly from within Cynap Core. Support for WebRTC web conferencing is also provided.

Capture your big ideas!



It's easy to create extra content material using our built-in digital whiteboard and annotation features, and multiple users can annotate on-screen at the same time if required.

Display & share your files easily



Share your data on-screen easily from cloud, network drives or mobile devices – even your laptop is no longer essential – just bring your content on a USB stick, or download it directly from the cloud!

vSolution Meeting Feature Pack



This optional room booking feature pack interfaces perfectly with your Outlook Calendar. It's easy to upload files in advance of a meeting, and automatically distribute them afterwards, and the on-screen quick tools bar ensures quick and easy control of all content.

Office 365 Feature Pack

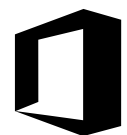

Access popular Office 365 apps directly from Cynap Core including Microsoft Teams (active Office 365 account required). Files are easy to open, work on collaboratively, and share with teammates.

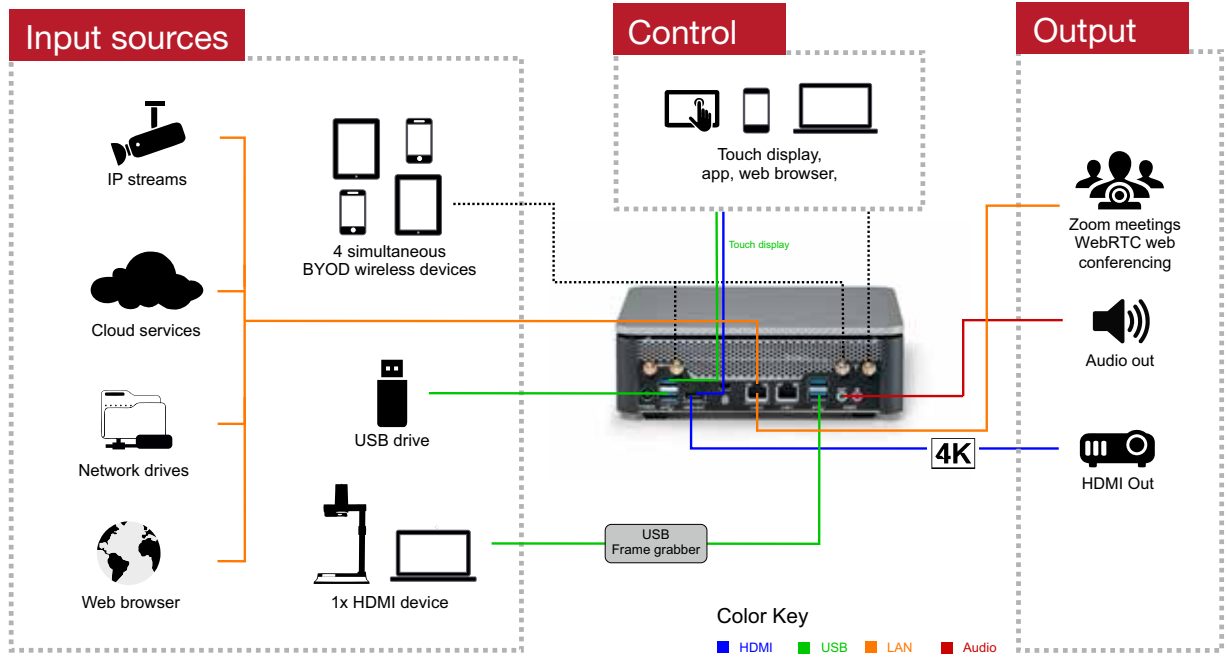

Technical specifications



Optional remote control

Features

Cynap Core

Operating system	Linux
Output resolution	2160p30, 1080p60, 1080p30, 720p60
Supported devices for wireless mirroring (up to 4K depending on device)	iOS, iPadOS, Android, Windows, macOS, Chrome OS
Supported mirroring protocols	AirPlay, Miracast (Peer-to-Peer and MICE), Chromecast, vSolution Cast
vSolution MATRIX compatible	Yes, client only
vSolution Link Pro remote admin software	Yes (included for Windows 10 desktop, Windows Server 2012 R2 & 2016)
Media Player: Supported image file formats	GIF, JPEG, BMP, PNG
Media Player: Supported document file formats	PDF, Word, PowerPoint, Excel, Text, HTML
Media Player: Supported video file formats	AVI, WMV, MOV, MP4, DivX, MKV, M4V, OGV
Media Player: Supported audio file formats	MP3, WMA, MKA, OGA, OGG
Touchback functionality	Yes, for Windows devices (Miracast & vSolution Cast)
Max. no. of on-screen windows	4
Cloud services	Yes, Google Drive, Dropbox, Box, Jianguoyun, OneDrive, WebDAV
Optional Office 365 Feature Pack	Yes
Optional vSolution Meeting Feature Pack	Yes
Access to network drives	Yes
Whiteboard and annotation	Yes
Protected/Open presentation modes	Yes
Web conferencing support	Zoom, WebRTC, Microsoft Teams
Customizable background image	Yes
Encrypt and save personal user settings	Yes, save onto USB stick
Integrated web browser and screensaver	Yes
Inputs/Outputs	HDMI Out x1, Rear USB 3.0 x4, Front USB 2.0 x1, Audio Line In x1, Audio Line Out x1, 1 GigE LAN port x2
Video input	HDMI In not supported (HDMI source possible via frame grabber if required)
Bluetooth device discovery	Yes
WLAN standards	802.11 ac/a/b/g/n (2.4 & 5GHz)
Network protocols	TCP/IP, FTP, HTTP, HTTPS, SNMP/NTP, SSL, SSH, UDP, LDAP, LDAPS
IP configuration	DHCP, Static (IP address, Subnet mask, Default gateway, DNS server), Proxy, Interface priority
Security authentication for LAN	IEEE 802.1X
Security encryption for wireless WLAN	WEP, WPA2, WPA2 Enterprise or IEEE 802.1X
RMS encryption	Yes
External controlling	Web interface, Visualizer, multi-touch display, room control system, keyboard/mouse, optional remote control
Dimensions (L x W x H)	203 x 196 x 67mm (7.99 x 7.71 x 2.63")
Power consumption	Max. 80W
Weight	1840g (4.05lb)
Optional accessories	Optional remote control, 19" rackmount, VESA mount (75mm /100mm)
Included accessories	Power supply, antennas
Limited warranty	3 years (optional extension to 5 years)

Your WolfVision Partner:



More information:

WOLFVISION®

www.wolfvision.com

Head Office:

WolfVision GmbH
6833 Klaus / Austria
Tel. +43 5523 52250
wolfvision@wolfvision.com

Japan Sales Office
WolfVision Co. Ltd.
Tel. +81 3 6233 9465
wolfvision.japan@wolfvision.com

USA Sales Office
WolfVision, Inc.
Tel. +1 770 931 6802
sales@wolfvision.us

Nordic Sales Office
WolfVision Nordic (Norway)
Tel. +47 9186 9736
wolfvision.nordic@wolfvision.net

UK Sales Office
WolfVision UK Ltd.
Tel. +44 1628 509 067
wolfvision.uk@wolfvision.com

Middle East Sales Office
WolfVision Middle East (Dubai)
Tel. +971 5617 40008
wolfvision.mideast@wolfvision.com

Asia Sales Office
WolfVision Pte. Ltd. (Singapore)
Tel. +65 6636 1268
wolfvision.asia@wolfvision.net

Germany Sales Office
WolfVision GmbH
Tel. 0800 9828 787
wolfvision.deutschland@wolfvision.com